

# SD9K

## CABLE CARRIERS HEAVY SERIES

Inner Height (A) 60mm	Code	Radius	(A)mm	(B)mm	(C)mm	(D)mm	Weight Kg/Mt
<ul style="list-style-type: none"><li>• Both up and down sides are openable</li><li>• Suitable for long distances</li><li>• Both up and down sides have complete covers (caps)</li><li>• Should be used in supporting tray</li></ul>	SD9K 100 R_01	150-170-200-220-285-350	60	100	80	140	2.600gr
	SD9K 140 R_01	150-170-200-220-285-350	60	140	80	180	3.000gr
	SD9K 200 R_01	150-170-200-220-285-350	60	200	80	240	3.600gr

Maximum working speed hızı :5M/S

Radius MUST be given in your orders. Example: **SD9K 100 R170**

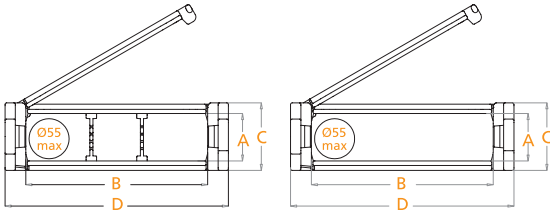

R mm	H mm	X mm	M mm	Y mm
150	100	380	290	630
170	100	420	310	730
200	100	480	360	820
220	100	520	390	891
285	100	650	425	1095
350	100	780	490	1299

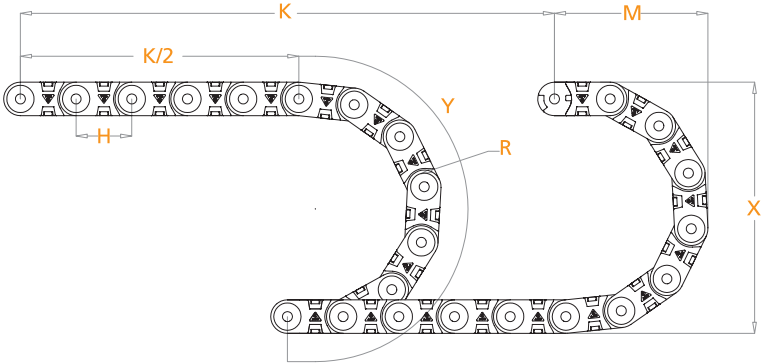

L: Total length to be used  
K: Movement distance  
Y: Radius  
$$L: \frac{K}{2} + Y$$



### IMPORTANT POINTS

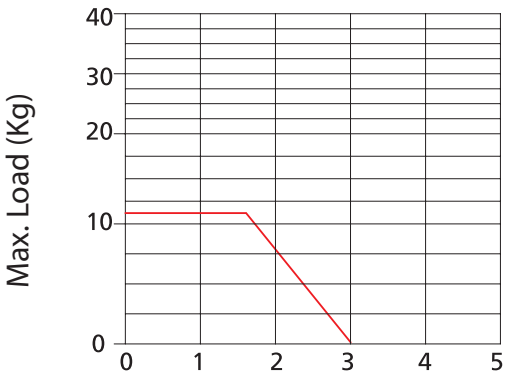

$\frac{K}{2}$  Max. Length without support

#### Self-supporting Capacity Diagram

Self-supporting capacity of the cable carrier according to weight of the cables and hoses

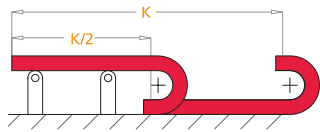

How to use support rollers:  
• Support rollers should be used after 4 meters  
• Make sure that the cap (cover) is fixed properly  
• Use an appropriate hand tool (screw driver) to open the cap  
• Be careful not to damage the fixing nail of the cap (cover)  
• Be sure that side stoppers, used to fix end brackets are fixed properly

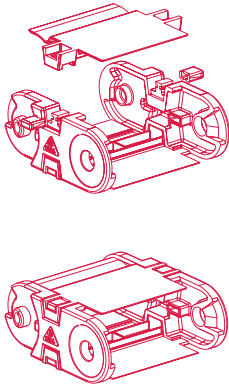

### How to choose end bracket

**End bracket**  
End brackets are the parts to be used to fix the cable carrier to the machine or equipment

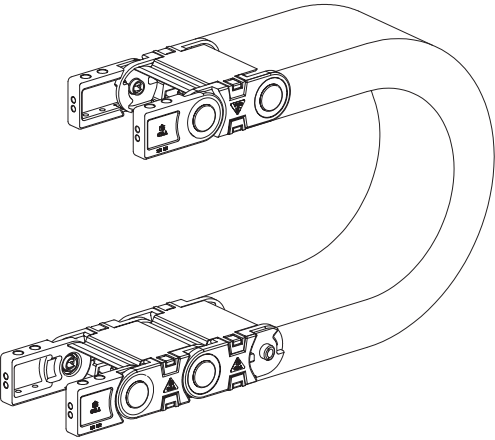

Should be attached to the both ends of the cable carrier

CABLE CARRIER CODE	END BRACKET CODE	A	B
SD9K 100 R01	SD9 B01	120	140
SD9K 140 R01	SD9 B01	160	180
SD9K 200 R01	SD9 B01	220	240

